

CRUISE AMERICA PRODUCT INFORMATION

STANDARD FEATURES WITH ALL MOTORHOMES

Power steering	Roof Air Conditioning
Power Brakes/ABS	AM/FM Radio
Cruise Control	Refrigerator/Freezer
Automatic Transmission	Combination Shower
Dash Air Conditioning	Fresh Water Flush Toilet
Furnace	Generator (except CT22/C25 in Canada)
3 Cook Top Burners	Rear Dual tyres
Microwave Oven	2 Wheel Drive

SPECIFICATIONS PER VEHICLE

NB: All vehicles are 30 amp

	C19	C25	C30
Exterior Dimensions (in metres)			
Length	6.15	7.6	9.1
Width	2.34	2.54	2.54
Height	3.72	3.72	3.72
Bed Dimensions (in metres)			
Cab Over Double	1.52 x 2.13	1.45 x 2.44	1.45 x 2.44
Dinette Conversion	.94 x 1.83	.97 x 1.78	.97 x 1.73
Rear bed	n/a	1.37 x 2.03	1.52 x 1.88
Couch	n/a	n/a	1.06 x 1.72
Holding Tank Capacities (gallons/litres)			
Water Heater	6/22	6/22	6/22
Fresh Water	20.5/76	40/151	40/151
Grey Water (sink/shower etc)	18/68	35/132	35/132
Black Water (toilet waste)	17/64	30/114	30/114
Gasoline/Petrol	40/151	55/208	55/208
Liquid Propane Gas	11/42	14/53	14/54
Maximum Number of Passengers	3	5	7
Minimum Driver Age	21	21	21
Under 25 Driver Supplement	zero	zero	zero
Extra Driver Charge	zero	zero	zero

C19 - Compact Motorhome

Accommodates a family of up to 3 people

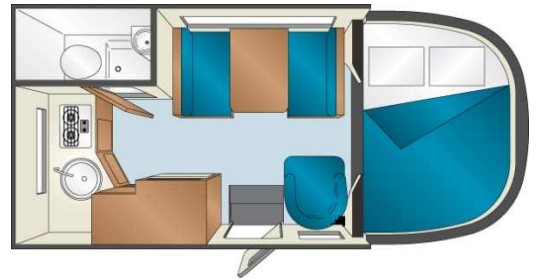

C25 - Standard Motorhome

Accommodates a family of up to 5 people

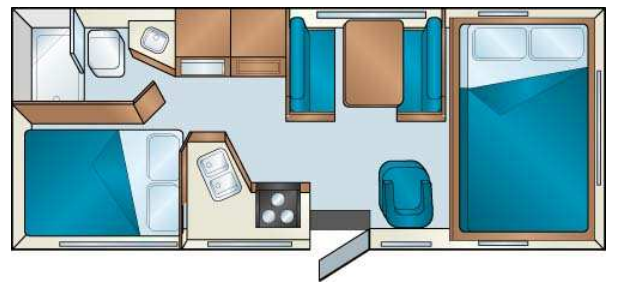

C30 - Large Motorhome

Accommodates a family of up to 7 people



This document was created with Win2PDF available at <http://www.win2pdf.com>.
The unregistered version of Win2PDF is for evaluation or non-commercial use only.
This page will not be added after purchasing Win2PDF.